

CRETÉ GLUE S® Flexible pre-mixed smooth, superior bonding **Tile adhesive C2 T**

Description : CRETÉ GLUE S® is a cement-based flexible, polymer modified tile adhesive offering outstanding flexibility that can fix tiles on old tiles substrates. It provides high initial and final adhesive strength, smooth easy application, moisture resistance and elasticity. It is qualified as absolutely non-slip (zero slipping of the tile) CRETÉ GLUE® is classified as C2 T according to EN12004. and EN 12002

Fields of Applications :

Thanks to its superior Elasticity and ease of application, **CRETÉ GLUE S®** can add value

- ✓ Absorptive or non-absorptive tiles
- ✓ Natural stone, decorative bricks, large tiles, glass mosaic tiles, marble and granite etc..
- ✓ Wall or floor application on various substrates, especially where particularly high adhesion, elasticity and moisture resistance are required.
- ✓ Old tile layers, floors with in-floor heating, metallic surfaces, swimming pools, gypsum boards etc.).
- ✓ Suitable for indoor or outdoor use.

Advantages :

- ✓ Superior Elasticity
- ✓ No need to remove old tiles (smartly economic).
- ✓ Higher labour productivity.
- ✓ Can be applied on almost any substrate including substrates subject to vibration.
- ✓ Suitable for almost any kind of smooth tiles

Technical data :

Form:	cementitious mortar
Colors:	grey, white
Water demand:	5.5kg/25 kg bag (depending on site conditions)
Application temperature:	from +5°C to +45°C (higher temp. requires pre-wetting)
Application thickness:	up to 15 mm
Slip:	≤ 0,5 mm
Pot life:	at least 2 h
Open time:	at least 20 min
Pointing on walls:	after 3-8 h
Pointing on floors:	after 24 h
Adhesive strength after:	
• 28 days:	≥ 1,50 N/mm ²
• heating in +70°C:	≥ 1,20 N/mm ²
• immersion in water:	≥ 1,30 N/mm ²
• 25 freeze-thaw cycles:	≥ 1,20 N/mm ²
Temperature resistance:	from -30°C to +90°C
Deformation ability	
according to EN 12002:	> 2,5 mm

All measurements were conducted according to EN 12004.

All measurements achieves the requirement of **C2 T grade EN12004**

Surface preparation :

- The surface to be overlaid must be clean, free of dust, grease, paint, loose material etc. Dampening of the substrate before application is recommended.
- Building surfaces must comply with building standards (codes) and/or consultant recommendations.
- Sand Bed thickness under Floor Tiles, should be maintained as necessary to obtain finish floor levels indicated on Approved Shop Drawings and Tile Designs, in case of screed underlayment, the screed pouring should be leveled to the same.
- Background to receive wall tiles on vertical surfaces are to be leveled and fully cured before fixing of tiles to avoid substrate failure.
- When applying on old tiles substrates, its highly recommended to check piping leakage before commissioning work, mechanical roughing of the old surface is not essential.

Directions for use :

Mixing:

- Mix in a clean container (preferably plastic). A hand mixing works well yet Power mixing saves considerable time and is recommended (electric drill operating at 450 to 650 rpm).
- **CRETÉ GLUE S®** is gradually added into clean tap water under continuous stirring, until a uniform paste is formed.
- The mixture should be left about 10 minutes to settle and should be stirred slightly again.
- Mixing in dirty buckets or failure to wash down the exposed container sides leads material to cause lumps and scratches and usually creates hard working material.

Application:

- The tile adhesive should be spread (combed) on the substrate using a notched trowel, in order to be uniformly applied on the whole surface a V-notch trowel for the small tiles and a square notch for the bigger tiles. The tiles should be fixed by pressing them in the desired position.
- The applied mixture must be covered with tiles within 20 minutes in order to avoid "skin" formation, i.e. before the adhesive film starts setting.
- For tiling on unstable substrates subject to vibrations or contraction-expansion effects, such as gypsum boards, chipboards, floors with in-floor heating, terraces, balconies etc. it is not essential to add any additive, yet in case the standards require the addition of an additive, the use of **CRETÉ LATEX®** is combatable with **CRETÉ GLUE S®**.

Coverage rate:

- 2.5 - 4,0 kg/m², depending on the trowel's notch size and the nature of the substrate.

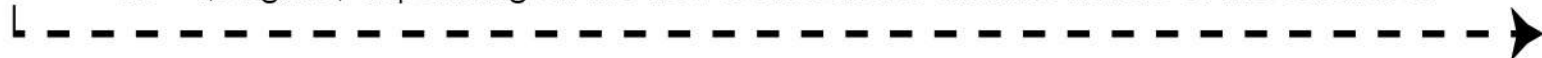

Regular tile application

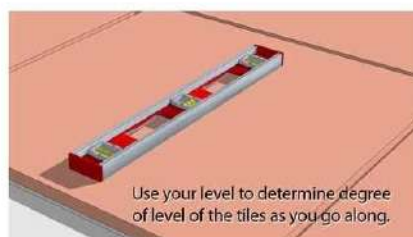
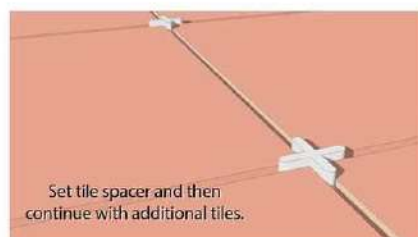
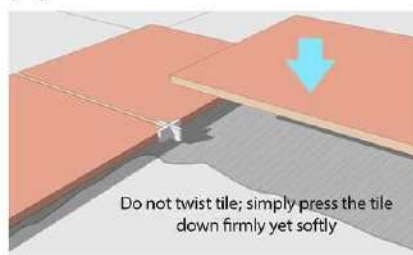
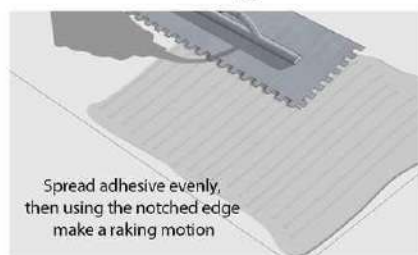

Tile fixation on cement board

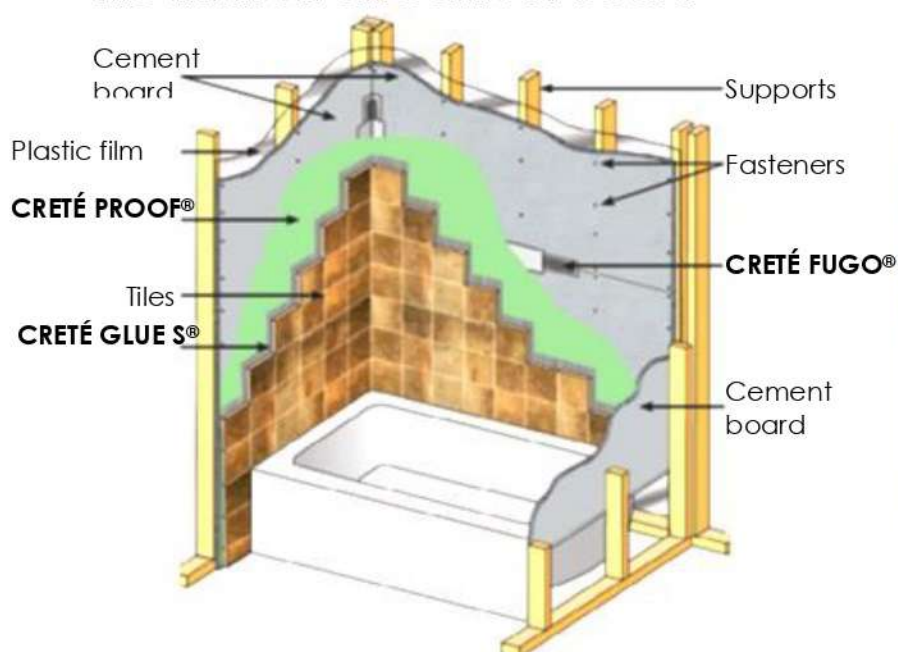

Tile fixation on old tiles or flexible beddings

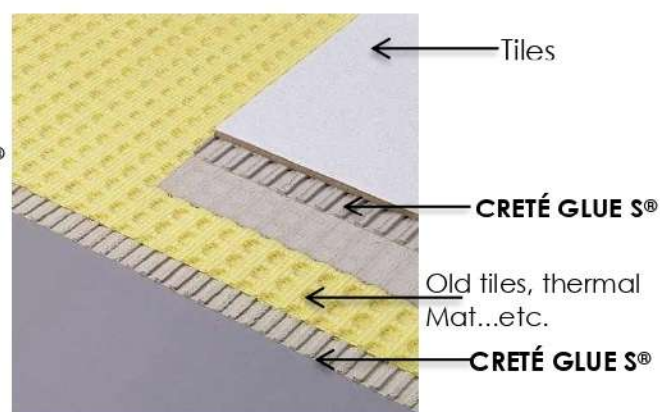

Fixation of cement board on wood with Tile on top

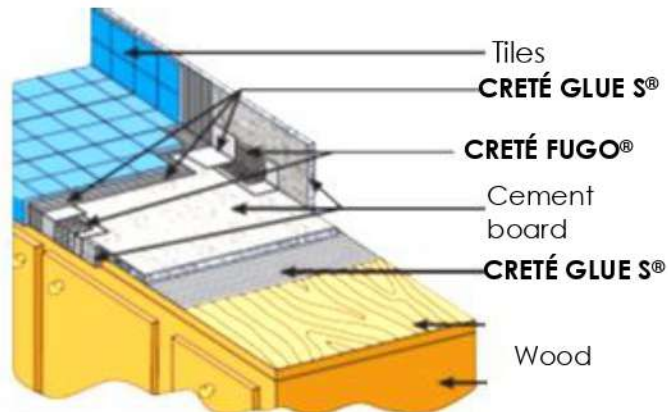
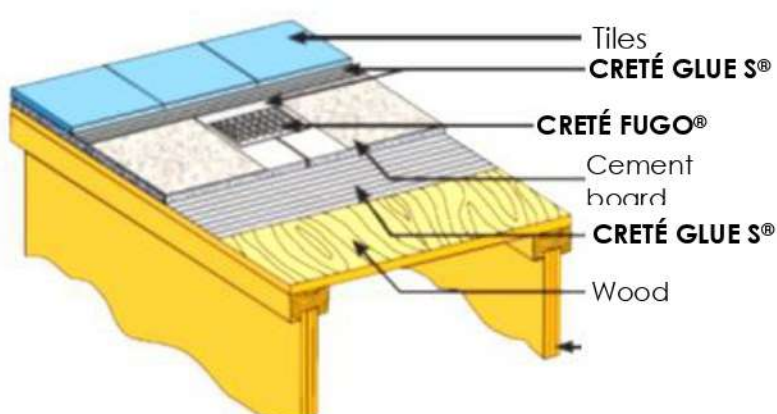

Packaging :

CRETÉ GLUE S® is supplied in sacks of 25 kg.

Storage :

Shelf-life is at least 12 months in dry, leak proof and moisture proof sheds. The shed for the storage should have minimum number of windows and close fitting doors. The bags should be stacked on wooden planks placed about 150 to 200 mm above the floor of the shed and a space of 450 to 600 mm should be kept all-round between the exterior walls and the stacks.

Safety & precautions :

By taking a few basic precautions, cement based products is one of the safest building materials known. Relatively few people involved in mixing, handling, and finishing cement based products have experienced injury. Protecting head, hands and skin should be sufficient to work safely. For more details please refer to our material safety data sheet. →

Legal :



The technical information and instructions supplied in this datasheet are based on the knowledge and experience of the Department of Research and Development of our company and on results from long-term applications of the product in practice. The recommendations and suggestions referring to the use of the product are provided without guarantee, since site conditions during the applications are beyond the control of our company. Therefore the user is responsible for confirming that the chosen product is suitable for the envisaged application. The present edition of this technical datasheet automatically cancels any previous one concerning the same product.

CRETÉ GLUE S® Flexible pre-mixed smooth, superior bonding **Tile adhesive C2 T**

CRETÉ GROUT 5W[®] Water resistant, smooth, shrinkage free superior bonding Tile grout CG2 (upto 5mm)

Description : CRETÉ GROUT 5W[®] is a cement-based flexible, polymer modified tile grout offering outstanding water resistance, flexibility and abrasion resistance. It provides high initial and final bonding strength, smooth easy application up to 5mm and homogenous decorative stable colors. CRETÉ GROUT 5W[®] is classified as CG2 according to EN13888.

Fields of Applications :

Thanks to its superior water resistance and abrasion resistance, **CRETÉ GROUT 5W[®]** can add value

- ✓ Absorptive or non-absorptive tiles up to 5mm width.
- ✓ Grouting of tiles in water structures such as swimming pools, water reservoirs...etc.
- ✓ Wall or floor application on different tiles and mosaic, especially where particularly high adhesion, elasticity and water resistance are required.
- ✓ Heavy traffic floors in public and administrative buildings

Advantages :

- ✓ Suitable for indoor or outdoor use.
- ✓ Exceptional abrasion and impact resistance.
- ✓ Extremely Low water absorption.
- ✓ Water repellent (hydrophobic joints).
- ✓ No crack formation.
- ✓ Superp adhesion to tile flanks.
- ✓ Low E-modulus and high deformability

Technical data :

Form:	cementitious mortar
Colors:	34 colors (please refer to the color chart)
Water demand:	1.25kg/5 kg bag (depending on site conditions)
Application temperature:	from +5°C to +45°C (higher temp. requires pre-wetting)
Application thickness:	up to 5 mm
Bulk density of dry mortar:	1,25 ± 0,40 kg/lit
Bulk density of fresh mortar:	1,60 ± 0,50 kg/lit
Application temperature:	from +5°C to +35°C
Abrasion resistance:	≤ 1000 mm ³
Compressive strength after:	
• 28 days:	34,00 N/mm ²
• 25 freeze-thaw cycles:	32,00 N/mm ²
Flexural strength after:	
• 28 days:	4,00 N/mm ²
• 25 freeze-thaw cycles:	4,50 N/mm ²
Drying shrinkage:	≤ 2mm/m
Water absorption after:	
• 30 min:	≤ 2 g
• 240 min:	≤ 5 g
Pot life:	at least 2 h at +20°C

All measurements were conducted according to EN 13888.

All measurements achieves the requirement of **CG2 grade EN13888**

Surface preparation :

- Allow the tile adhesive bed to set firmly before commencing grouting. Uncured adhesive may bleed through the joints and discolor the grout. Also, there is a risk of destroying the bond by moving tiles, always be consistent with the period between fixing and grouting.
- The tile surface must be clean, free of dust, grease, loose material etc. Dampening of the joints before application is recommended.
- When grouting in bathrooms and/or swimming pools wall tiles should be grouted first then floor tiles to allow good control of job conditions.

Directions for use :

Mixing:

- Mix in a clean container (preferably plastic). A hand mixing works well yet Power mixing saves considerable time and is recommended (electric drill operating at 450 to 650 rpm).
- **CRETÉ GROUT 5W®** is gradually added into clean tap water under continuous stirring, until a uniform paste is formed.
- The mixture should be left about 10 minutes to settle and should be stirred slightly again.
- Mixing in dirty buckets or failure to wash down the exposed container sides leads material to cause lumps and scratches and usually creates hard working material.

Application:

- The amount of water used to mix the grout is very important. An overly wet dilutes the grout, causing shade variations and leads to reduced strength.
- Apply the grout with a rubber float in a diagonal direction forcing it into joints to fill them completely. Remove surplus grout from the surface of the grout at once, using the float like a scraper. Wait until the grout achieves an initial set and then, avoiding excessive water, wipe the complete area thoroughly with a damp sponge to obtain a smoother joint. Rinse the grout sponge often. This will prevent residues on the tile that will be hard to clean later. Polish the tiles with a clean, dry cloth when the film of grout on the surface has only just dried.
- For tiling on unstable substrates subject to vibrations or contraction-expansion effects, such as gypsum boards, chipboards, floors with in-floor heating, terraces, balconies etc. it is not essential to add any additive, yet for outstanding performance and/or the standards require the addition of an additive, the use of **CRETÉ LATEX®** is combatable with **CRETÉ GROUT 5W®** (changing in the standard color will occur).

Coverage rate:

The consumption of **CRETÉ GROUT 5W®** depends on the tile dimensions and the joint width. The following cases are mentioned indicatively (values in g/m²):

Tile Dimensions (cm)	Joint width			
	2 mm	3 mm	4 mm	5 mm
2 x 2 x 0,3	1.300	1.500	---	---
10 x 10 x 0,6	400	600	800	1.000
15 x 15 x 0,7	310	470	630	780
20 x 20 x 0,7	240	360	480	590
20 x 30 x 0,7	200	300	400	490
30 x 30 x 0,8	190	280	370	460



1- Fix tiles using **CRETÉ GLUE®** or **CRETÉ FIX®** system & adjust the tiles to the desired grout thickness using the right spacer.

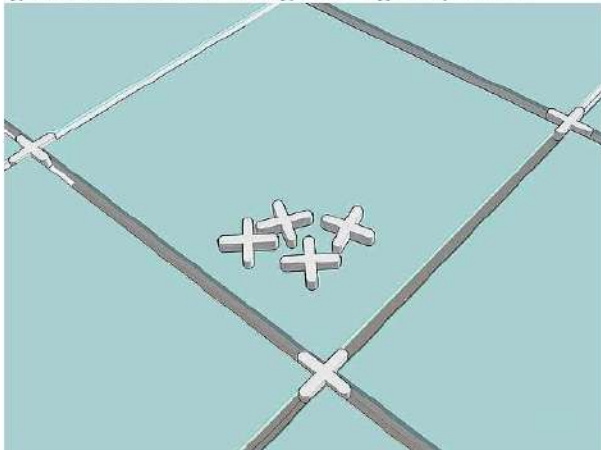

2- Allow the tile adhesive bed to set firmly before commencing grouting for at least 24 hours

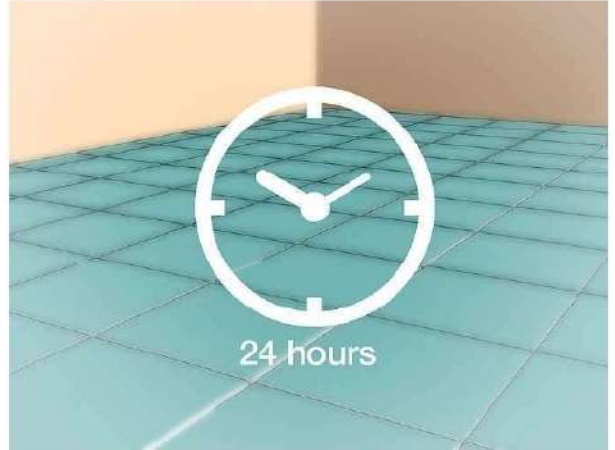

3- **CRETÉ GROUT®** is gradually added into clean tap water under continuous stirring, until a uniform paste is formed.



4- Apply **CRETÉ GROUT®** with a rubber float in a diagonal direction forcing it into joints to fill them completely



5- Wait for 20min (initial set) then, avoiding excessive water, wipe the complete area thoroughly with a damp sponge to obtain a smoother joint.

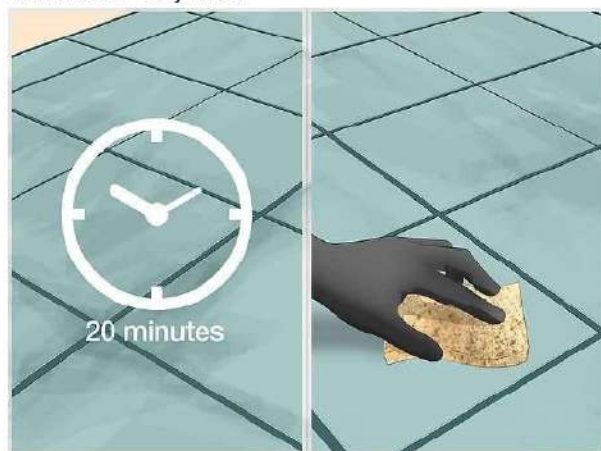

6- Polish the tiles with a clean, dry cloth when the film of grout on the surface has just dried. It's preferable to wait for 72 hours before traffic exposure.

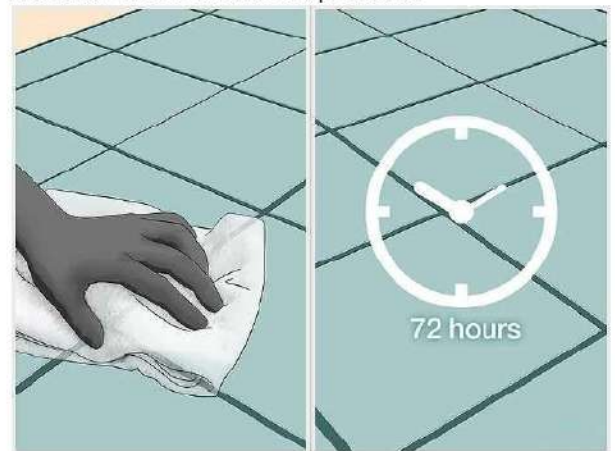

Packaging :

CRETÉ GROUT 5W® is supplied in sacks of 1,5,20 kg.

Storage :

Shelf-life is at least 12 months in dry, leak proof and moisture proof sheds. The shed for the storage should have minimum number of windows and close fitting doors. The bags should be stacked on wooden planks placed about 150 to 200 mm above the floor of the shed and a space of 450 to 600 mm should be kept all-round between the exterior walls and the stacks.

Safety & precautions :

By taking a few basic precautions, cement based products is one of the safest building materials known. Relatively few people involved in mixing, handling, and finishing cement based products have experienced injury. Protecting head, hands and skin should be sufficient to work safely. For more details please refer to our material safety data sheet. →

Legal :



The technical information and instructions supplied in this datasheet are based on the knowledge and experience of the Department of Research and Development of our company and on results from long-term applications of the product in practice. The recommendations and suggestions referring to the use of the product are provided without guarantee, since site conditions during the applications are beyond the control of our company. Therefore the user is responsible for confirming that the chosen product is suitable for the envisaged application. The present edition of this technical datasheet automatically cancels any previous one concerning the same product.

CRETÉ GROUT 5W®

Water resistant, smooth,
shrinkage free superior bonding
Tile grout CG2 (upto 5mm)